



Condominium



1 Bed



2 Baths

PROPERTY DETAILS

A Beach & Boaters Dream to live on the water & across the street from the beach in Lauderdale By The Sea! This quaint community features, Private Beach Access, Boat Dockage under \$1,050 annually with No fixed bridges and just minutes to Inlet. Also has Large Heated Pool, Clubhouse, Covered Patio overlooking the Boats and Canal, Shuffleboard, Putting Range, and Assigned Parking right in front of the unit. The building went through a Renovation its 40 year inspection with ALL Assessments Paid. This 1st floor, 1/2 is renovated and move in ready. Also features a Murphy Bed/Bonus Room and Extra Storage Locker, Low HOA Fee, Boat Dockage max is 32ft, Dock slip when available, Close to all attractions & restaurants. Come & relax here in LBS.. Its vacant easy to view & move in read so, call today.



John Sullivan
207-754-9492

johnsullivan@realestateinsoflo.com
<https://www.realestateinsoflo.com/>



Scan code
for more
property
details



1481 S Ocean Blvd, Pompano Beach, FL 33062 – 1481 S Ocean Blvd APT 106E_Floor 1

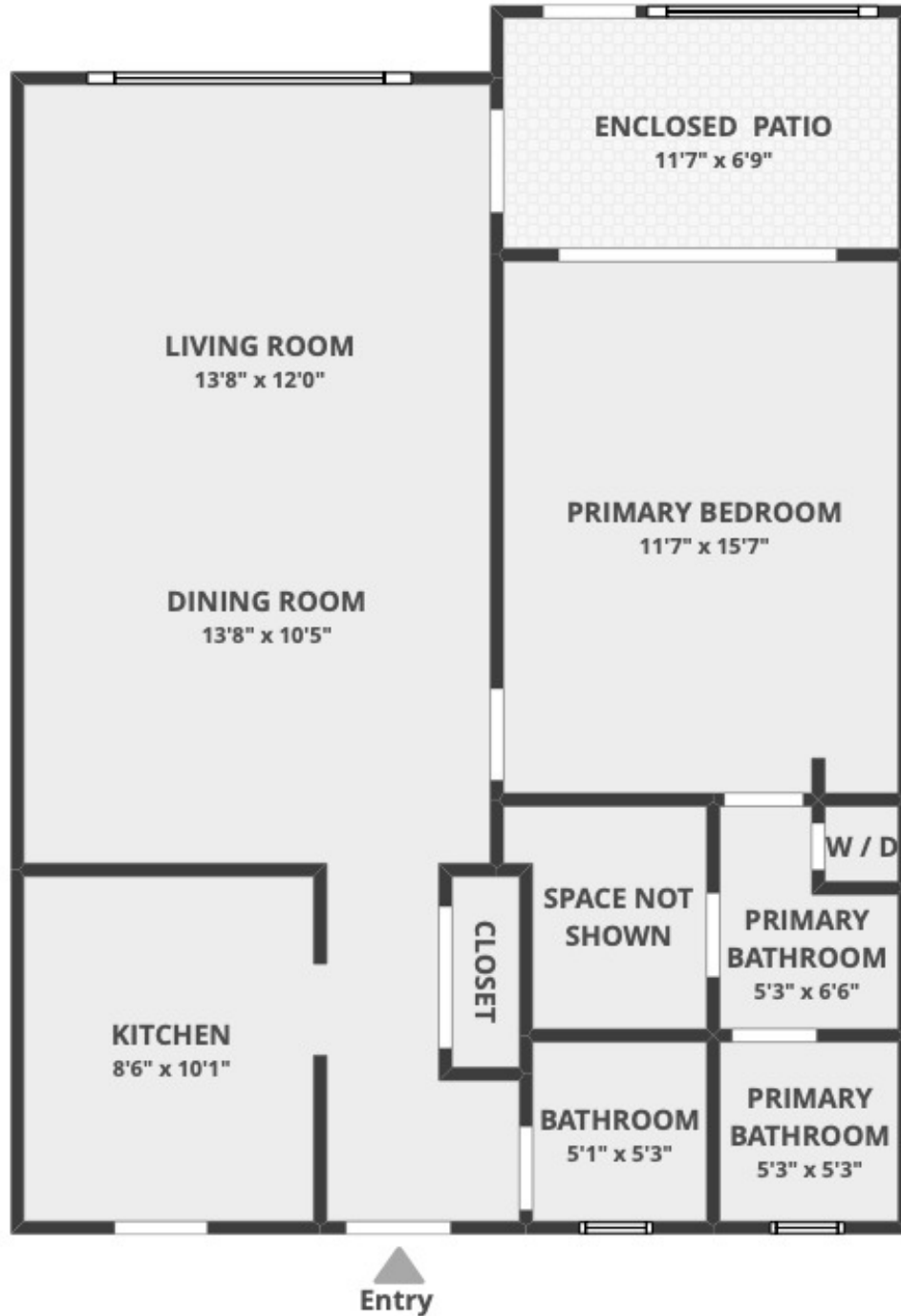

All dimensions are approximate and subject to independent verification

Disclaimer: Sizes and Dimensions are Approximate, Actual May Vary.



John Sullivan
207-754-9492
johnsullivan@realestateinsoflo.com
<https://www.realestateinsoflo.com/>



Scan code
for more
property
details

